

# Hiab Grapples for handling timber and recycling materials





## A Grapple for Every Need

The Hiab range of grapples features several alternatives for handling timber and recycling materials.

The timber grapples are designed for demanding work. They penetrate log piles, straighten logs and load them effortlessly. A practical design provides the light-weight grapples with durability and power, while the single-cylinder design with few moving parts guarantees a long and carefree service life. With the

yellow Hiab timber grapples you can load quickly and reliably year after year.

### **Hiab Lasts**

These grapples are designed for hard wear and tear, taking the special requirements of handling demolition waste and scrap into consideration.

Due to their durable materials and design, the red Hiab grapples are the best choice for handling recycling materials of any kind.

Hiab grapples can be equipped with a lock valve. A centralised lubrication system is also available for most models.



## X43 X53

The X series grapples, X43 and X53 are eminently suitable for mid-sized truck loaders for loading pulpwood and logs.

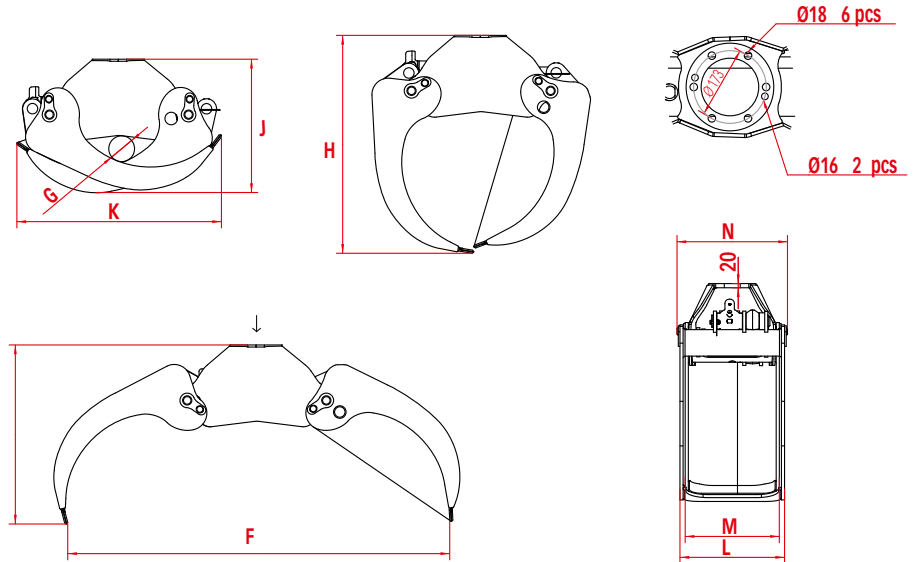

## FX26 FX36 FX42

The FX series is designed to withstand the demanding use of forestry machines. The FX26 and FX36 are suited for forestry cranes and lightweight truck loaders. The FX42 is suited for heavy forestry machine and skidder cranes.

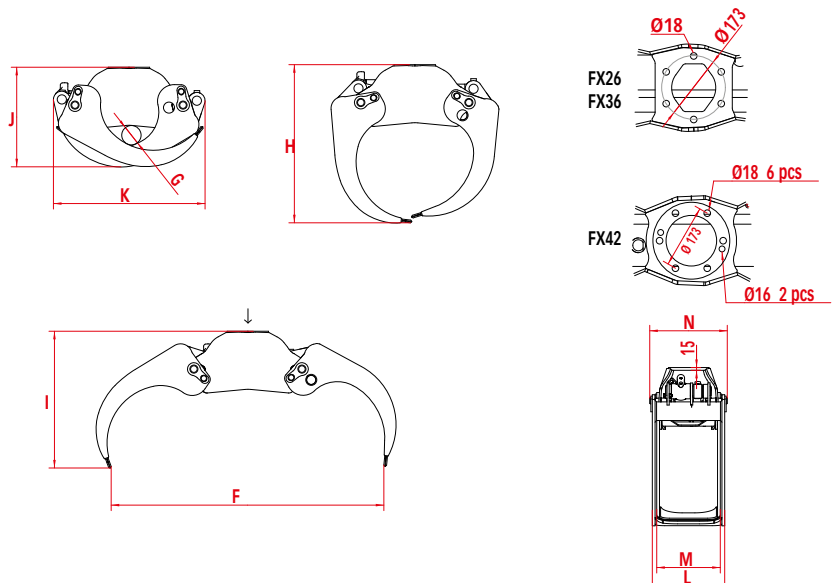



## TX56 TX56B

The heavy TX series grapples are used in industrial cranes in addition to truck loaders. The TX56 is optimised for loading raw timber using heavy truck loaders, while the reinforced TX56B is also suitable for use on excavators.

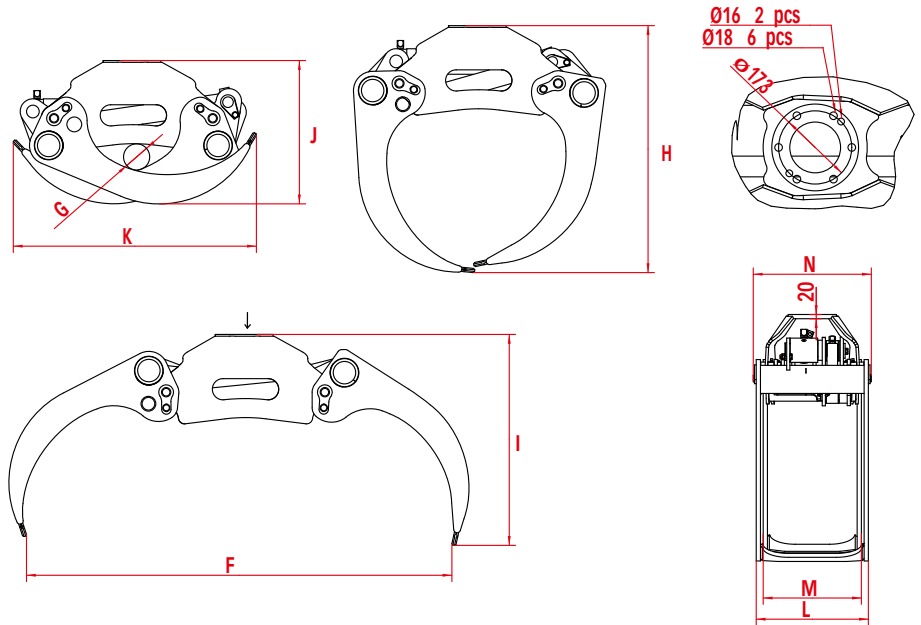

## TX86B TX811B

The heavy TX86B and the TX811B, with its wider jaws, can be installed on industrial cranes and excavators.

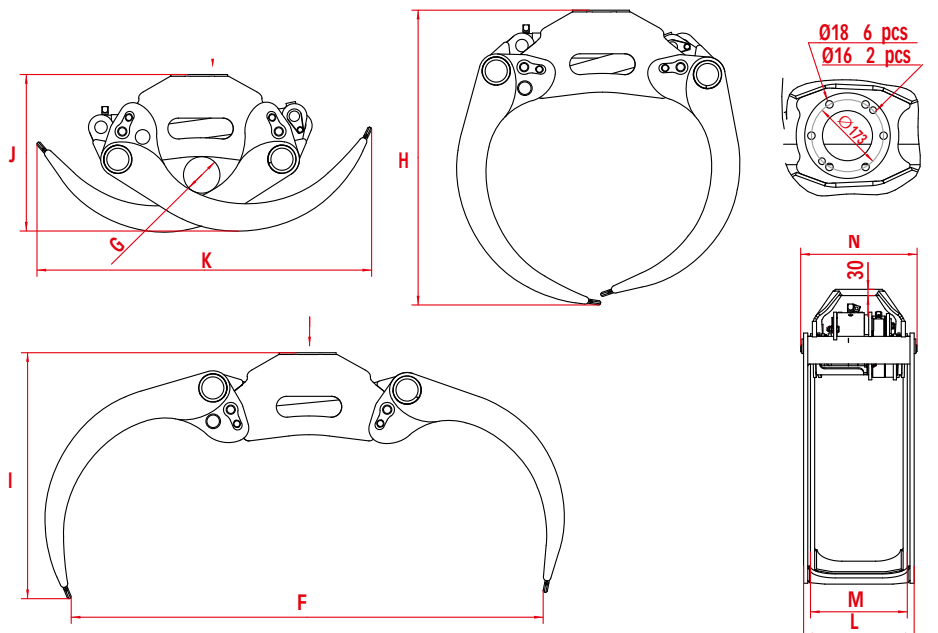



## RX31 RX51

The RX series grapples are designed for handling logging waste and refuse. The RX31 grapple is used in forestry machine loaders, and the RX50 is suitable for larger loaders.

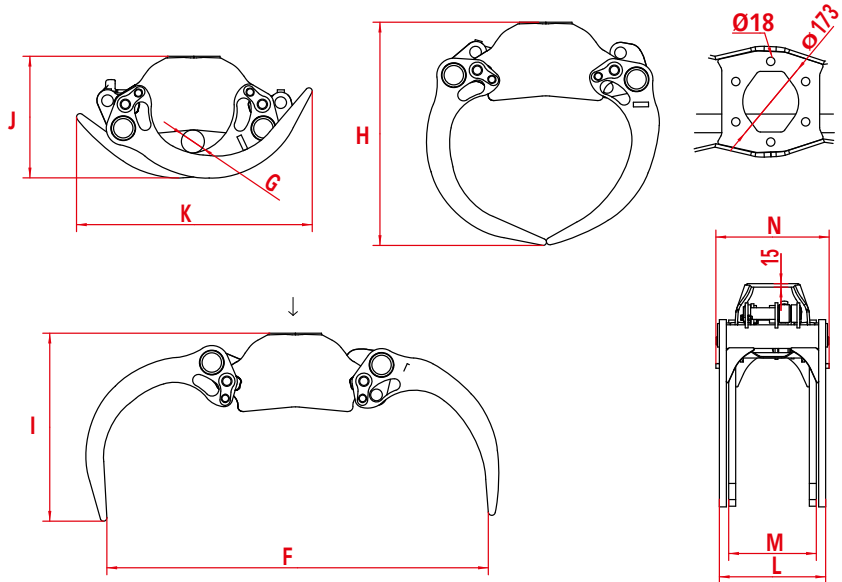

## PX20 PX40

The PX series grapples are well suited to handling individual logs. The PX20 is intended for industrial cranes used in timber processing lines. The PX40 is designed for use in light skidder cranes.

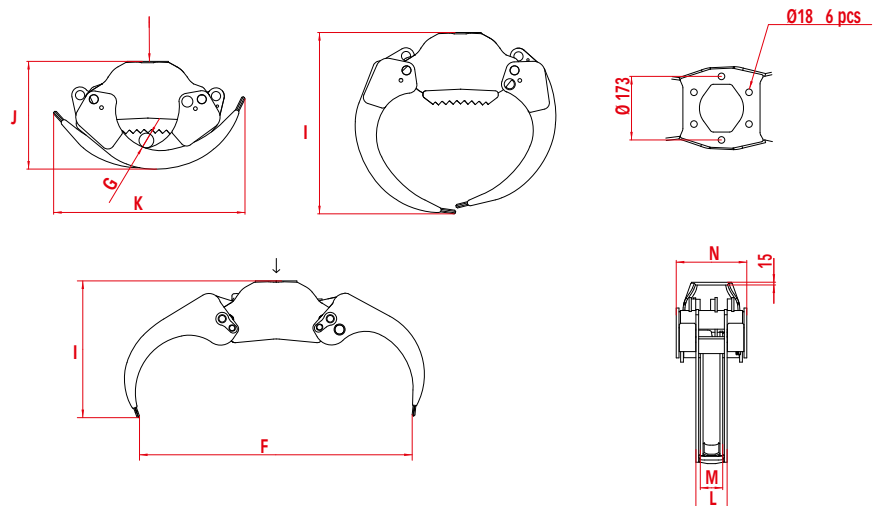



## For Hard Wear and Tear

Hiab features the RC range for handling recycling materials, having been specifically designed for this in co-operation with professionals. Because handling demolition waste and

scrap causes much wear and tear, the steel used in these grapples is much more wear-resistant than normal. The grapples' open tips act as effective rakes when collecting scrap.



### RC30 RC50 RC50-67

The RC series grapples are designed for handling recycling material and demolition waste, the RC30 for medium cranes, and the RC50 and RC50-67 (with its denser teeth) are suitable for larger cranes.

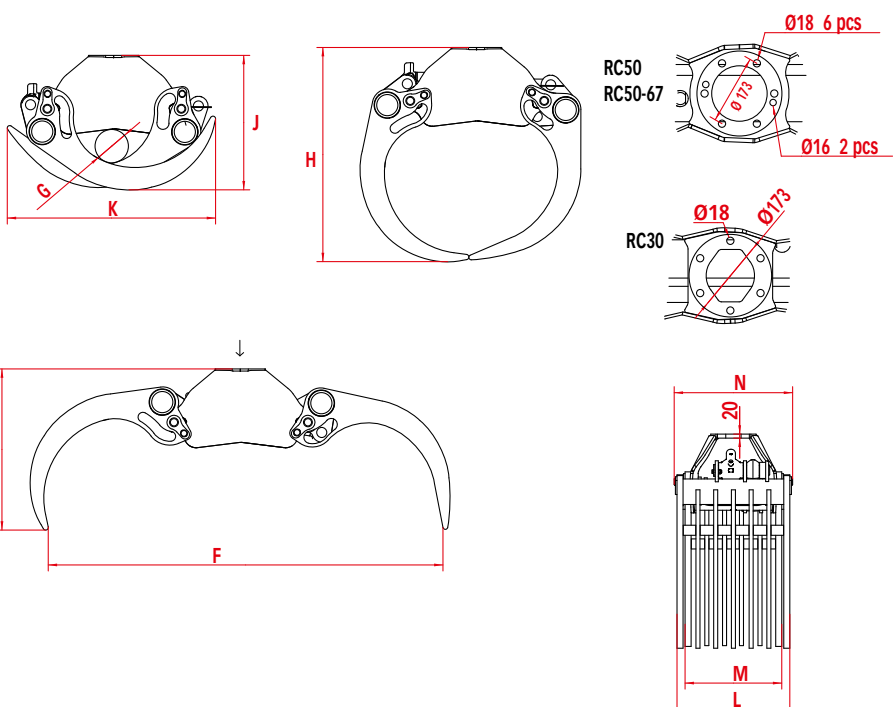

# Hiab Grapples technical data

| Model          | Holding area<br>m <sup>2</sup> | Max. load<br>kg | Max. working pressure<br>MPa | Jaw pressure (jaw against jaw)<br>kN/MPa | Weight<br>kg | F. Max grip width<br>mm | G. Min. diameter<br>Ø mm | H. Height, jaw against jaw<br>mm | I. Height, opened<br>mm | J. Height, closed<br>mm | K. Width, closed<br>mm | L. Width, outer jaw<br>mm | M. Width, inner jaw<br>mm | N. Max. width<br>mm |
|----------------|--------------------------------|-----------------|------------------------------|--|--------------|-------------------------|--------------------------|----------------------------------|-------------------------|-------------------------|------------------------|---------------------------|---------------------------|---------------------|
| <b>PX20</b>    | 0.2                            | 3000            | 20                           | 12/20                                    | 135          | 1100                    | 40                       | 915                              | 880                     | 590                     | 840                    | 145                       | 40                        | 245                 |
| <b>PX40</b>    | 0.4                            | 4000            | 25                           | 11.9/25                                  | 185          | 1600                    | 80                       | 985                              | 840                     | 585                     | 1045                   | 170                       | 122                       | 412                 |
| <b>RX31</b>    | 0.35                           | 4000            | 25                           | 14.1/25                                  | 200          | 1640                    | 100                      | 960                              | 805                     | 520                     | 1010                   | 456                       | 376                       | 486                 |
| <b>RX51</b>    | 0.5                            | 5000            | 23                           | 17/23                                    | 265          | 1960                    | 165                      | 1055                             | 800                     | 660                     | 1035                   | 560                       | 480                       | 590                 |
| <b>FX26</b>    | 0.25                           | 4000            | 25                           | 14.1/25                                  | 165          | 1485                    | 105                      | 860                              | 745                     | 540                     | 825                    | 394                       | 346                       | 422                 |
| <b>FX36</b>    | 0.35                           | 4000            | 25                           | 13.1/25                                  | 175          | 1570                    | 105                      | 925                              | 785                     | 570                     | 935                    | 394                       | 346                       | 422                 |
| <b>FX42</b>    | 0.4                            | 6000            | 24                           | 19/24                                    | 250          | 1825                    | 120                      | 1040                             | 855                     | 635                     | 975                    | 520                       | 460                       | 548                 |
| <b>X43</b>     | 0.4                            | 5000            | 23                           | 18/23                                    | 220          | 1825                    | 120                      | 1040                             | 855                     | 635                     | 980                    | 500                       | 450                       | 528                 |
| <b>X53</b>     | 0.5                            | 5000            | 23                           | 17/23                                    | 225          | 1985                    | 165                      | 1075                             | 810                     | 670                     | 1040                   | 500                       | 450                       | 528                 |
| <b>TX56</b>    | 0.5                            | 9000            | 27                           | 21.7/27                                  | 340          | 2010                    | 120                      | 1165                             | 995                     | 675                     | 1150                   | 530                       | 464                       | 558                 |
| <b>TX56B</b>   | 0.5                            | 9000*           | 27                           | 21.7/27                                  | 345          | 1975                    | 120                      | 1165                             | 1015                    | 675                     | 1150                   | 530                       | 464                       | 558                 |
| <b>TX86B</b>   | 0.8                            | 9000*           | 27                           | 19.1/27                                  | 360          | 2260                    | 175                      | 1415                             | 1180                    | 750                     | 1605                   | 530                       | 464                       | 558                 |
| <b>TX811B</b>  | 0.8                            | 9000*           | 27                           | 19.1/27                                  | 455          | 2260                    | 175                      | 1415                             | 1145                    | 750                     | 1605                   | 1000                      | 930                       | 1000                |
| <b>RC30</b>    | 0.35                           | 4000            | 25                           | 12.5/25                                  | 235          | 1640                    | 130                      | 960                              | 805                     | 565                     | 1000                   | 456                       | 376                       | 484                 |
| <b>RC50</b>    | 0.5                            | 5000            | 23                           | 17/23                                    | 350          | 1960                    | 165                      | 1065                             | 800                     | 665                     | 1035                   | 560                       | 480                       | 588                 |
| <b>RC50-67</b> | 0.5                            | 5000            | 23                           | 17/23                                    | 405          | 1960                    | 165                      | 1065                             | 800                     | 665                     | 1035                   | 560                       | 480                       | 588                 |

\* Max. load down 2000 kg

We reserve the right to make changes. Illustrations, drawings and data are not always in accordance with the latest version or standard model in production. The models in the pictures may present special equipment or colours.

*Cargotec improves the efficiency of cargo flows on land and at sea - wherever cargo is on the move. Cargotec's daughter brands, Hiab, Kalmar and MacGregor are recognised leaders in cargo and load handling solutions around the world. Cargotec's global network is positioned close to customers and offers extensive services that ensure the continuous, reliable and sustainable performance of equipment. [www.cargotec.com](http://www.cargotec.com)*



[www.cargotec.com](http://www.cargotec.com)  
[www.hiab.com](http://www.hiab.com)